

ROBUS®

QUALITY PRODUCTS BY LED GROUP

SUSPENSION KIT FOR 300x1200 PANEL

RAMSUS-3W

PLEASE READ INSTRUCTION BEFORE COMMENCING INSTALLATION AND RETAIN FOR FUTURE REFERENCES.

! Electrical products can cause death or injury, or damage to property. If in any doubt about the installation or use of this product, consult a competent electrician

Note:

Product technical information and specification may change over time without prior notification. For the latest technical information please visit our web site www.ledgrouprobust.com.au

Installation

- 1 Ensure mains supply is switched off before commencing work
- 2 Choose suitable location for the panel
- 3 Mark fixing positions on the ceiling, before cutting ensure that the holes does not impinge on joists, pipe work, cables or other building services.
- 4 Attach base of suspension kit to the ceiling using the screws provided, ensure that they are secure.
- 5 Attach suspension wire to base and screw in tight
- 6 Attach the four brackets to the two sides of panel, ensure that they are secure.
- 7 Attach suspension wire hook the triangle on four plates.
- 8 Adjust length of suspension wire by pressing nipple on top of panel support, ensure that all two wires are equal (tie up excess wire)
- 9 Connect supply to driver

Note: The drivers and connector must be fixed to the back of LED panel by adhesive tape

Information for the Product user:

1. Please note the requirement to dispose of Waste Electrical & Electronic Equipment separately from household waste (WEEE marked with crossed out wheelie bin symbol).
2. Please consider your role in contributing to re-use and recycling by returning this product at end of life to a collection centre for waste electrical equipment or a Civic Amenity site, or to a retail outlet from which you are purchasing a replacement.
3. This equipment may contain substances that are hazardous to health and the environment if disposed of carelessly. It is important that it is separated from normal household waste and recycled in the WEEE chain
4. The "crossed out wheelie bin symbol" on a product indicates this equipment must not be disposed of in normal household waste, but should be disposed of according to local WEEE regulations

The Installation must be carried out by a qualified electrician

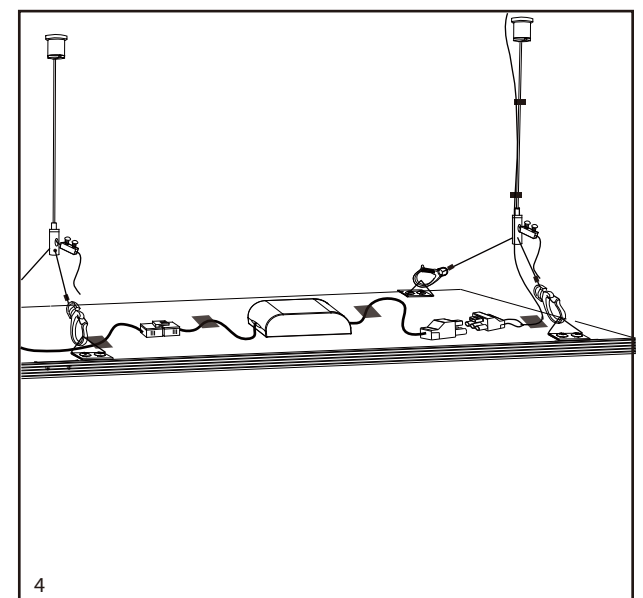
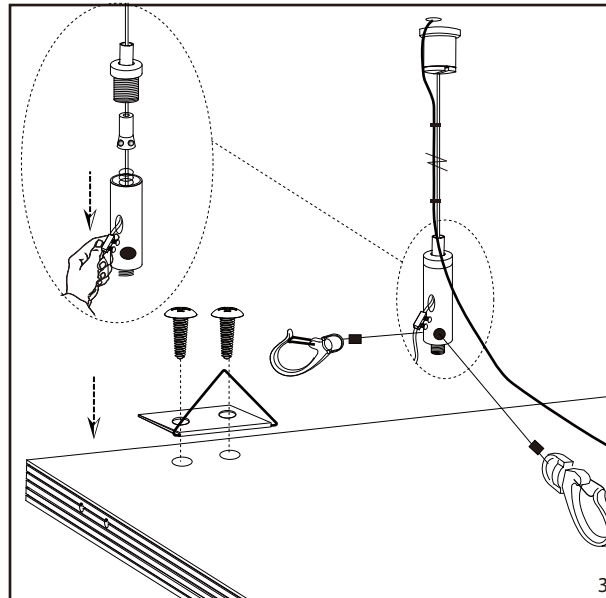
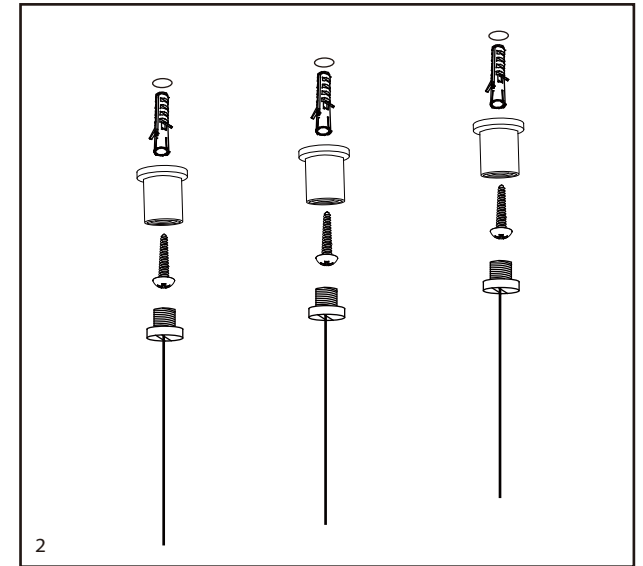
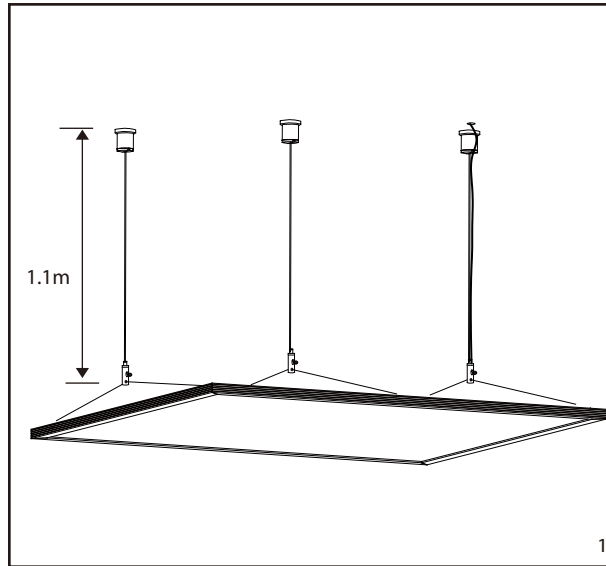

LED Group Australasia
9/210 Queensport Road North
Murarrie
QLD 4172
Australia

Tel: +61 73893 1488
Fax: +61 73112 1927
Email: purchases@ledgrouprobust.com.au
Website: www.ledgrouprobust.com.au

